

4908 Old Stage Road  
 4-Bedroom Septic Proposal  
 GB Construction Services, LLC  
 Harnett County

0.699 Ac. Total  
 - 0.019 Ac. Road R/W  
 0.680 Ac. Net

\*Not a Survey  
 Sketched from a plot plan supplied by owner

System: Gravity to D-Box  
 Lines: 3-5 (345')  
 0.4 LTAR  
 18" Max Trench Bottom  
 Accepted Status System  
 Repair: T&J Panel Block - 50% reduction  
 Lines: 1-2 (200+)  
 0.4 LTAR  
 18" Max Trench Bottom

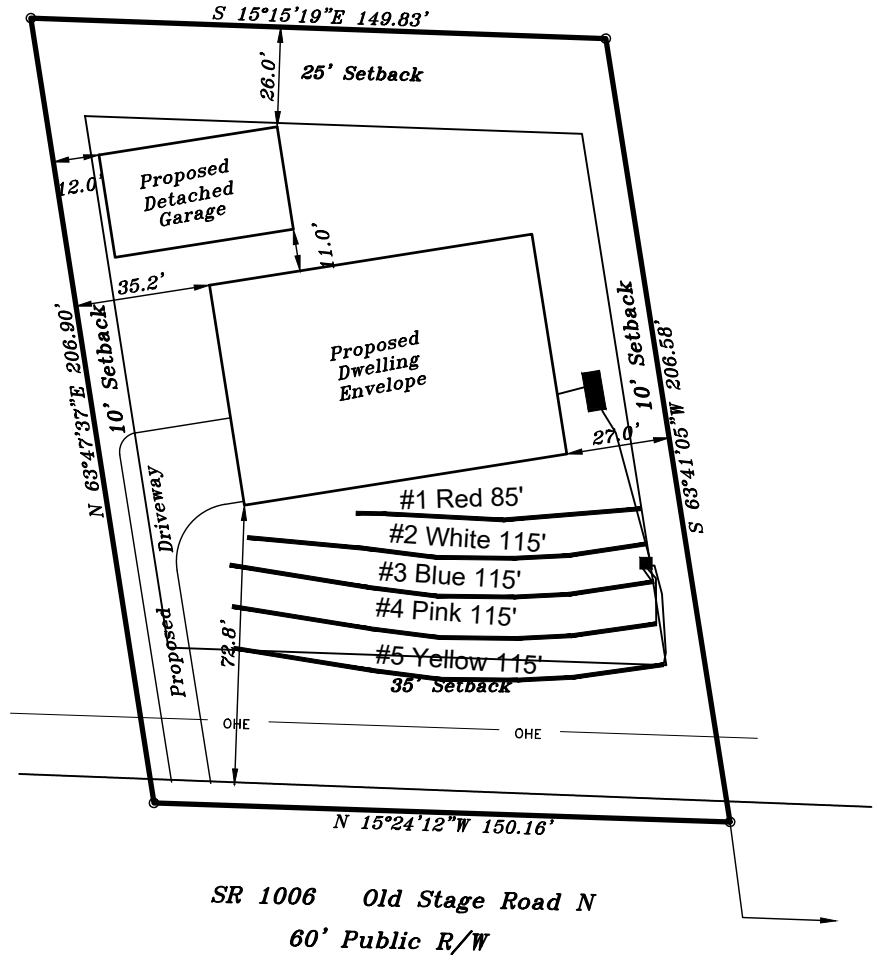

\*\*1000 Gallon Septic Tank  
 Tank and trenches to be located minimum of 10'  
 from any property line and minimum of 5'  
 from any building foundation.  
 \*Do Not Cut, Fill, or Alter Drainfield or Repair Area  
 \*Comply with all setbacks

Adams  
 Soil Consulting  
 919-414-6761  
 Job #1539  
 3-5-23

GRAPHIC SCALE  
 1" = 50'

